

VIRZOOM™



VZ-EA2
Product Manual

IMPORTANT SAFETY INFORMATION

1. Read this entire manual before assembling and using the VirZOOM. VirZOOM can only be used safely if it is assembled, maintained and used properly. It is your responsibility to ensure that all users of the VirZOOM are aware of all warnings and precautions.
2. Before using VirZOOM you should consult your doctor to determine if it is safe for you to engage in vigorous aerobic exercise.
3. Be aware of what your body is telling you while using VirZOOM. Stop immediately if you experience pain, tightness in your chest, irregular heartbeat, extreme shortness of breath, dizziness or nausea. If you do experience any of these symptoms, consult your doctor before using VirZOOM again.
4. Keep small children and pets away from VirZOOM. It is designed for use by adults and young adults only.
5. Use the VirZOOM on a solid, flat level surface with a protective cover for your floor or carpet. Using VirZOOM on thickly padded or plush carpet could result in hazardous instability. For safety, leave a few feet of open space all around it. Do not use or store VirZOOM in an excessively hot or cold or humid environment.
6. Before using the VirZOOM, check to make sure the nuts, bolts and pedals are securely tightened. After extended use some parts may need to be replaced. Periodically check your VirZOOM for wear and tear. If you hear any unusual noise coming from the VirZOOM, stop using it until the problem has been rectified.
7. Always use the VirZOOM as instructed. Do not stand up on the pedals or sit on the handlebars. Do not sit with your weight off the back of the seat.
8. Make sure the seat is adjusted to your height. You should be able to put the balls of your feet on the floor while seated on VirZOOM.
9. Wear suitable clothing while using VirZOOM. Avoid loose clothing which could get caught in the pedal cranks. Avoid tight clothing which restricts movement.
10. Designed for players 4'4" to 6'2" in height & up to 260lbs in weight (1.32 to 1.88 meters & up to 118KG). Use of VirZOOM by persons outside of this range is likely to result in damage to the VirZOOM and injury to the person.
11. Always get seated on VirZOOM and place your feet on the pedals before covering your eyes with your VR head-mounted display. Make sure that any cords or cables are secured where they won't interfere with your pedaling and won't get tangled in the pedals.
12. When VirZOOM is not in use it should be switched off, folded and stored in a dry place. It can be cleaned with a damp cloth. Be careful when moving VirZOOM around not to bang the handlebar grips or brain box into anything. These parts are relatively fragile.

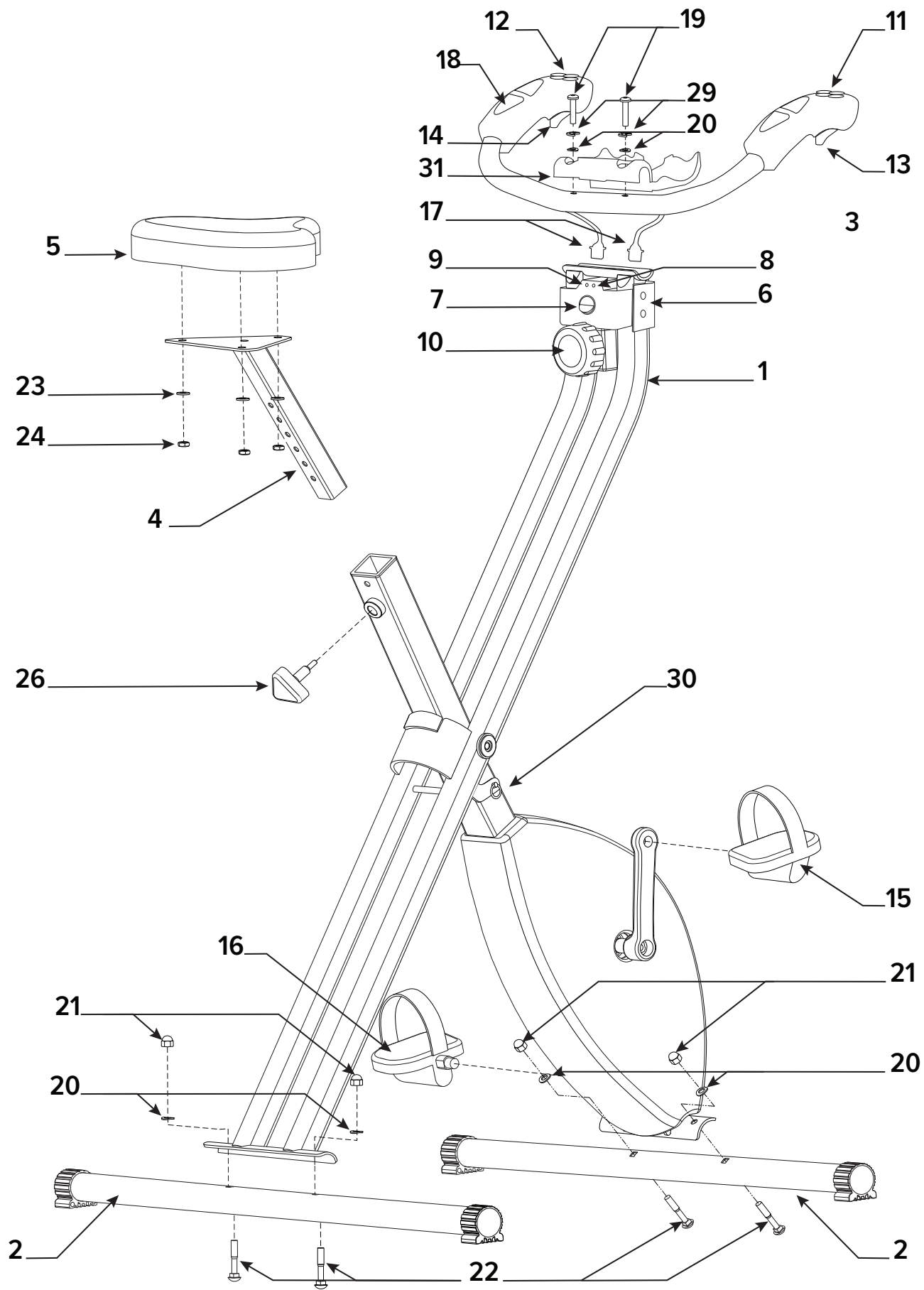

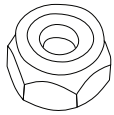

24 Nylon Lock Nut
(qty, 3)

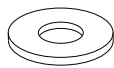

23 Flat Washer
(qty, 3)



20 Arc Washer
(qty, 6)



29 Split Lock Washer
(qty, 2)

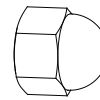

21 Domed Nut
(qty, 4)

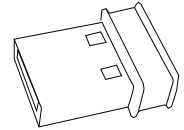

28 USB Dongle (qty, 1)
(inside battery compartment)

(nuts, bolts and washers can be found loosely installed on the appropriate hardware)

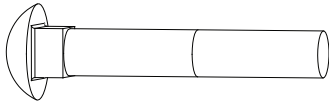

22 Carriage Bolt
(qty, 4)

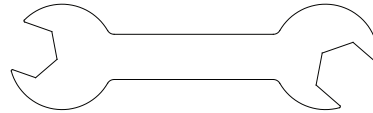

27 Flat Wrench (qty, 1)

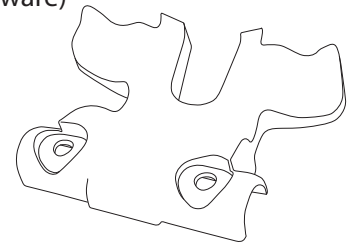

31 DUALSHOCK® 4 Cradle (qty, 1)



25 Allen Wrench (qty, 1)



19 Allen Head Bolt (qty, 2)

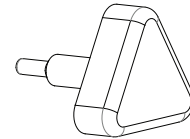

26 Seat Height Pin (qty, 1)

No.	Description	Qty
1	Frame	1
2	Frame Base	2
3	Handlebar	1
4	Seat Post	1
5	Seat	1
6	Brain Box	1
7	ON/OFF Switch	1
8	Connection Status LED	1
9	Battery Status LED	1
10	Resistance Knob	1
11	ABXY Buttons	1
12	Directional Buttons	1
13	Right Trigger	1
14	Left Trigger	1
15	Pedal Right	1

No.	Description	Qty
16	Pedal Left	1
17	Button Connector	2
18	Heart-rate Sensor	2
19	Allen Head Bolt	2
20	Arc Washer	6
21	Domed Nut	4
22	Carriage Bolt	4
23	Flat Washer	3
24	Nylon Lock Nut	3
25	Allen Wrench	1
26	Seat Height Pin	1
27	Flat Wrench	1
28	USB Dongle	1
29	Split Lock Washer	2
30	Frame Locking Pin	1
31	DUALSHOCK® 4 cradle	1

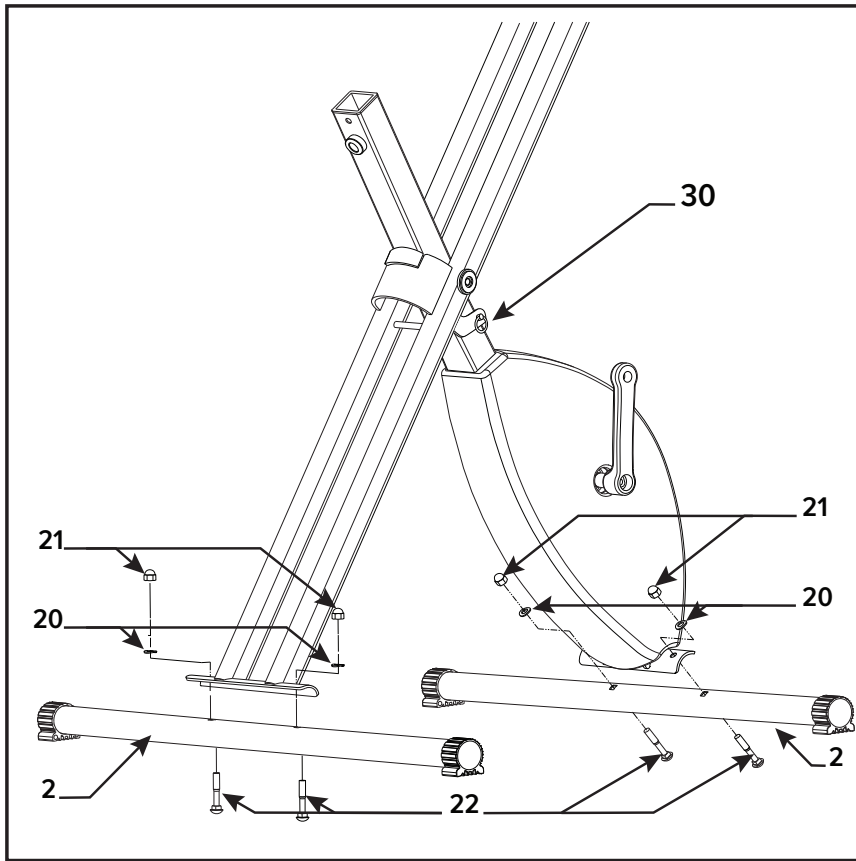

STEP 1

Remove the locking pin (30) from the storage position, open the frame fully and insert the frame locking pin (30) in the open position.

Attach the two frame bases(2) to the main frame(1) using four sets of domed nuts(21), arc washers(20), and carriage bolts(22). Tighten them with the flat wrench(27). Rotate the rubber base ends until they are flat on the ground.

STEP 2

Align the seat(5) with the seat post(4) as shown. Fasten them together with three sets of flat washers(23) and nylon lock nuts(24). Tighten them with the flat wrench(27).

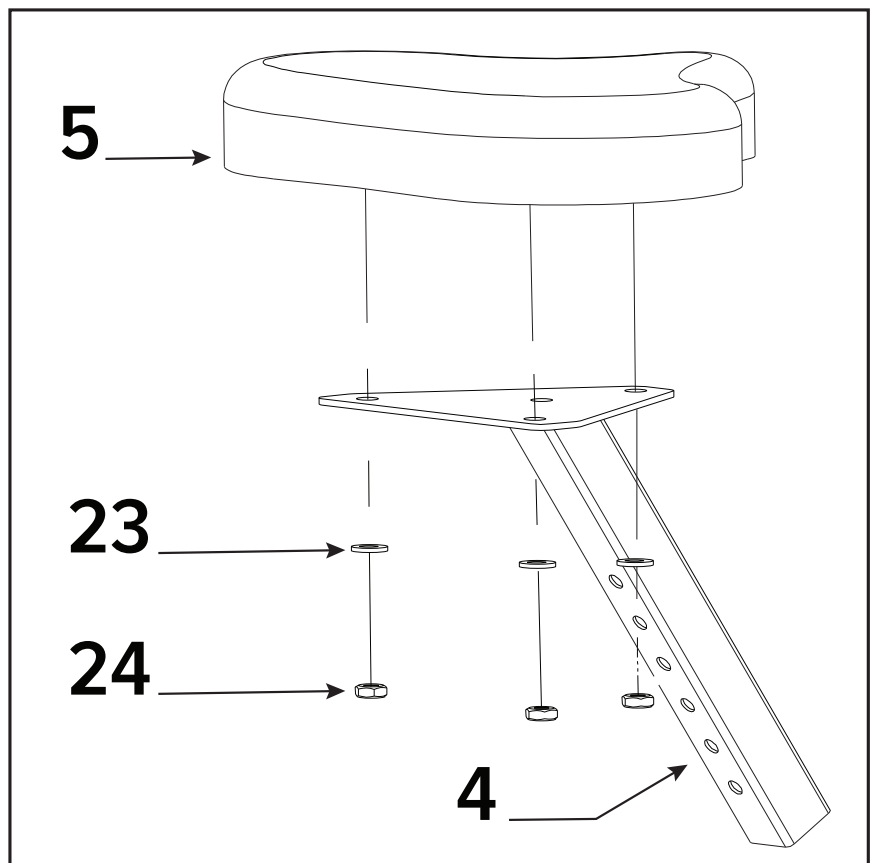

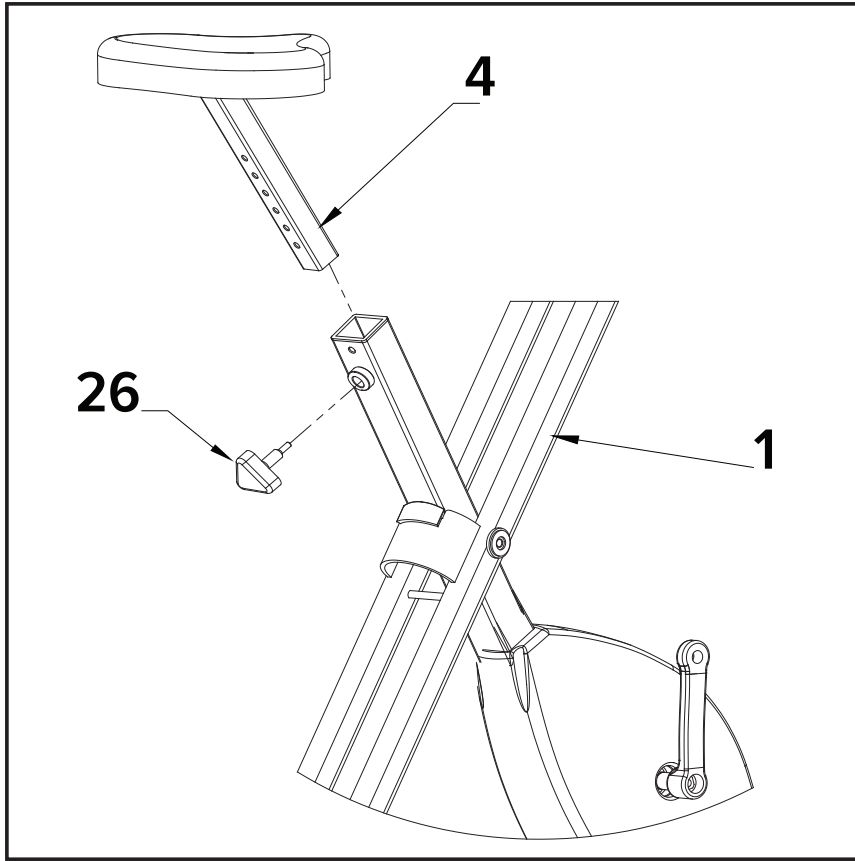

STEP 3

Insert the seat post(4) into the frame(1) and line up the holes. Secure the seat in position with the seat height pin(26). Tighten the pin fully by turning it clock-wise.

IF THE RED WARNING LABEL IS VISIBLE THEN THE SEAT IS SET TOO HIGH. NEVER ATTEMPT TO USE YOUR VIRZOOM WHEN THE RED WARNING LABEL IS VISIBLE.

STEP 4
Hold the handlebars(3) in place while you plug the button connectors(17) into the brain box(6) as shown.

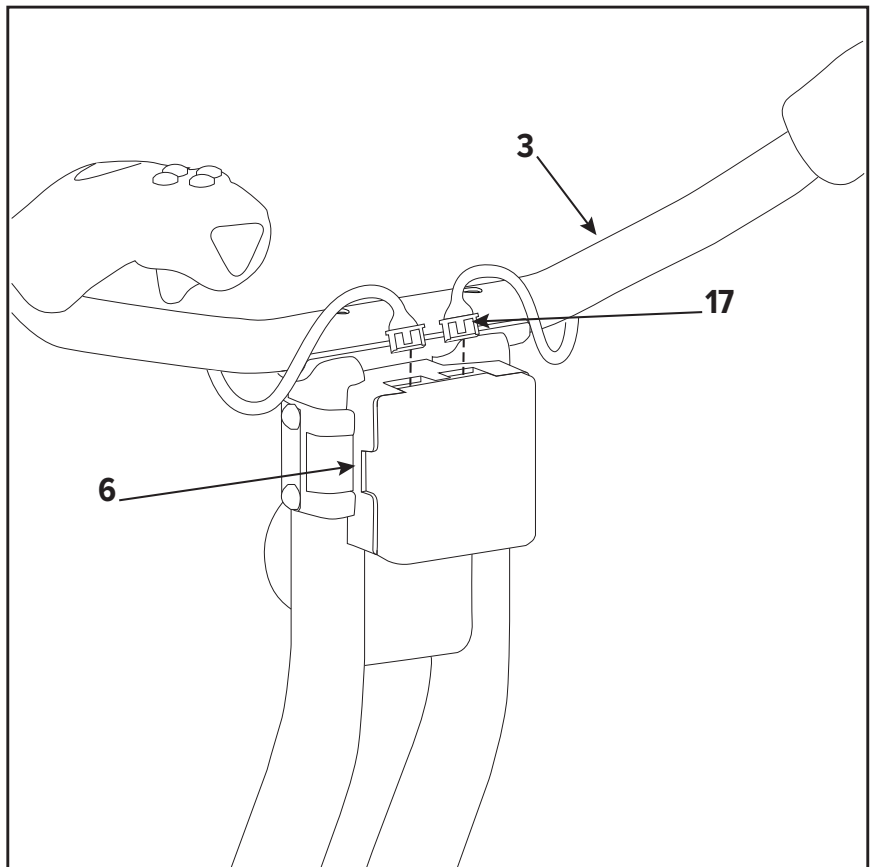

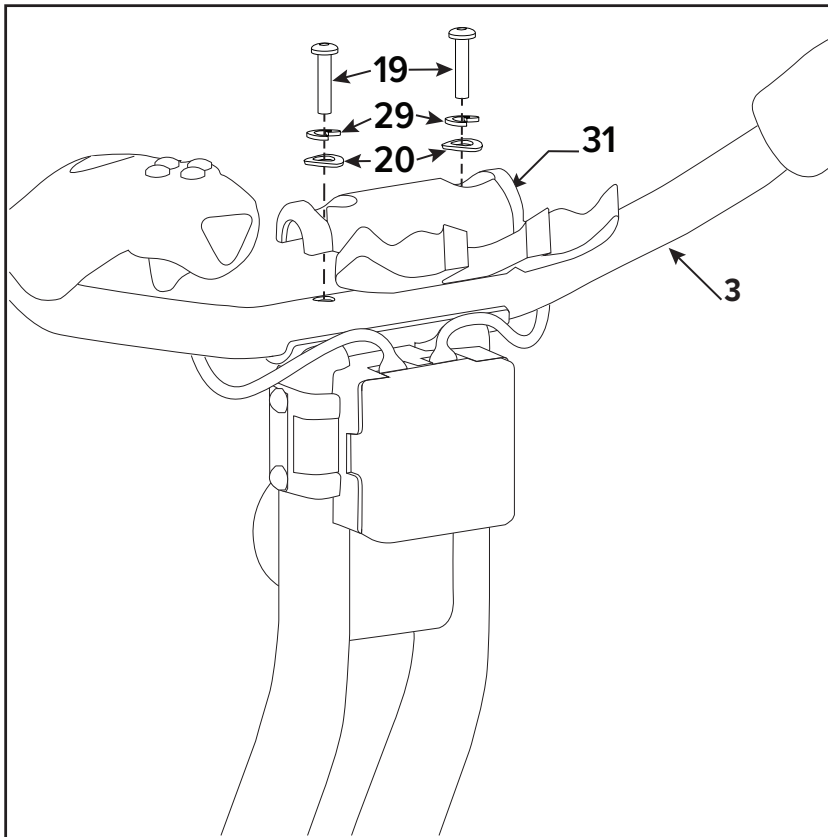

STEP 5

Fit the DUALSHOCK®4 cradle (31) onto the handlebars(3) as shown, tucking the button cables into the recess. Attach the handlebars(3) to the frame(1) using two arc washers(20), two split lock washers(29) and two allen bolts(19). Gently tighten using the allen wrench(25), being careful not to crack the plastic.

STEP 6

Open the battery compartment on the brain box(6) by pressing in on the sides until the tabs slide easily out. Remove the USB dongle (28) and put it aside. Install 2 AA batteries as shown (batteries not included). Replace the battery cover.

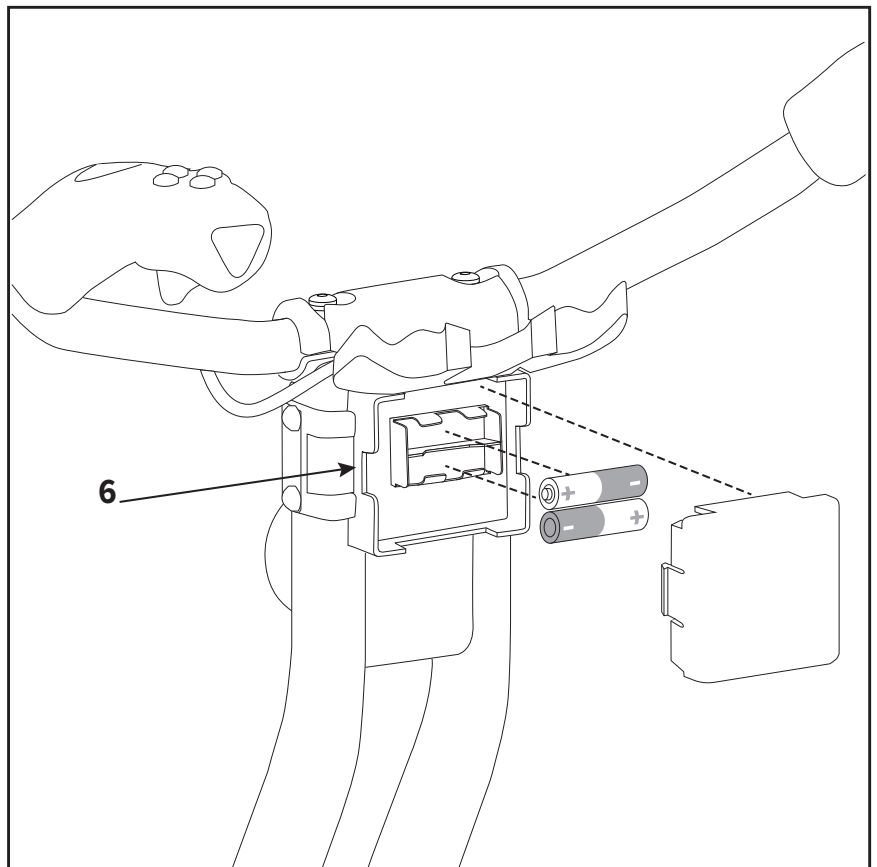

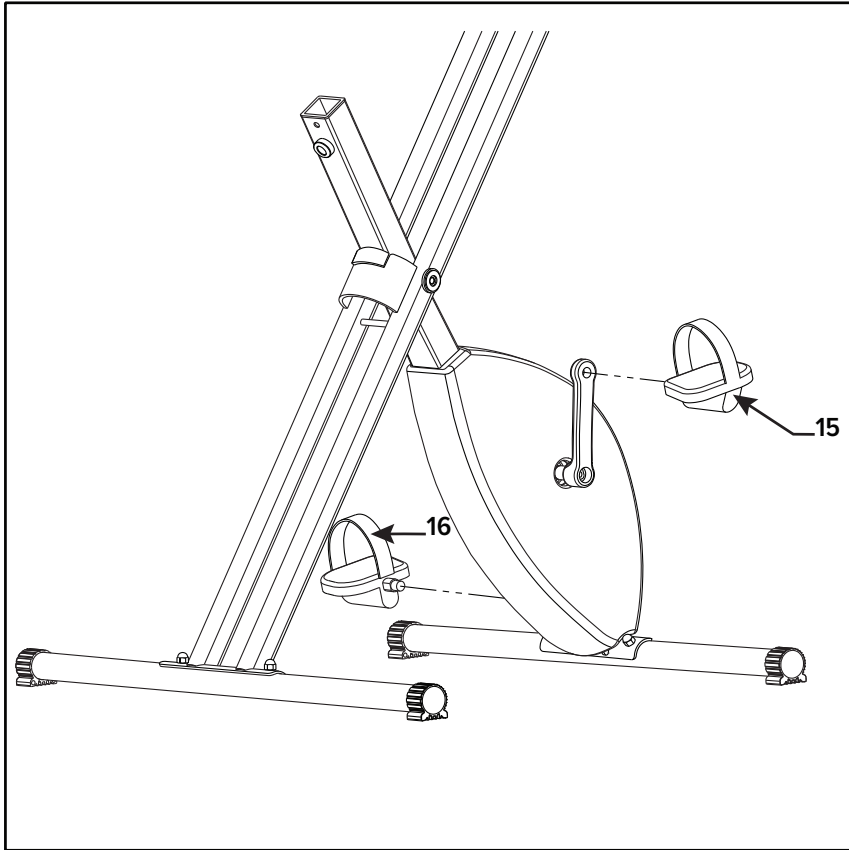

STEP 7

The pedals(15 & 16) are marked “L” and “R” - Left and Right. Connect them to their corresponding crank arms. Note that the right pedal will be threaded on clockwise, but the left pedal will be threaded on counter-clockwise. This is so that the pedals will not loosen themselves as you pedal.

If desired attach the pedal straps to the pedals using the tabs on the sides on the pedals.

Hardware Assembly is complete! If you haven't yet read the important safety information on page 1, this would be a good time to do so.

Getting Started with **VIRZOOM™**

SET UP YOUR SYSTEM:

See www.virzoom.com/setup for additional tips on setup, and www.virzoom.com/manual for more information about features and troubleshooting tips.

- Set up your VirZOOM near your PC or PlayStation 4, away from direct sunlight, with a few feet of elbow room on either side of it.
- Ensure that your Virtual Reality System can easily reach your VirZOOM. Spend a few minutes taping down, or otherwise securing your VR Head Mounted Display (HMD) cables so that they will not be tripped over, or get tangled in the VirZOOM pedals.
- Ensure that your position-tracking devices are able to “see” your VR HMD when seated on the VirZOOM.
- Plug the VirZOOM USB dongle into your PC or PlayStation® 4. The USB dongle provided does not contain the VirZOOM software; it provides a secure bluetooth pairing with your VirZOOM.

GET THE SOFTWARE:

Playstation® VR users, the VirZOOM software is available in the PlayStation Store. You will also need to go to www.virzoom.com/register and create an account in order to unlock all the features you are entitled to.

Oculus Rift® and **HTC® Vive** users, VirZOOM games can be downloaded as a collection called VirZOOM Arcade from Steam, an online game service. If you don't already have Steam set up, be sure to do the following:

1. Go to the Steam website and click the green Install button in the upper right
2. Launch the Steam application you just installed and create a Steam account on Steam (note this is not your VirZOOM account)
3. If you use an HTC Vive, you also need to install SteamVR
 - In Steam, click the Tools menu
 - Scroll down to “SteamVR” in the list
 - Right-click on SteamVR and choose Install
4. Finally, install VirZOOM Arcade

When the game starts up the first time, it will present you with a registration code that you enter at virzoom.com/register to create an account. You'll then need to check your email to verify your account.

START PLAYING:

Launch the VirZOOM application on your system. Flip the power switch(7) to On (shows “I”). The green LED(8) will flash to confirm.

Get on your VirZOOM, and put your feet on the pedals. Holding either trigger should “wake up” the VirZOOM, and connect it to your system. This may take several seconds. Success is indicated by the green LED(8) being lit steadily.

The Red LED(9) indicates low batteries.

In order for the heartrate sensors(18) to work properly, each hand needs to be contacting both sensors on the grips.

Pedal and adjust the resistance knob(10) to a level that seems good to you. Put your VR HMD on and follow the in-game prompts.

GET HELP:

Check the Forums: <https://www.virzoom.com/forums>

Submit a support ticket by emailing support@virzoom.com. Be aware that this email address goes to a real person, who works normal business hours in the Eastern Time Zone (GMT -5).

The VirZOOM team thanks you for your purchase! Please visit www.virzoom.com/forums to give your feedback on features and games you'd like to see. Help us shape the future of VirZOOM!

PlayStation and DUALSHOCK are registered trademarks and PS4 is a trademark of Sony Computer Entertainment, Inc. Oculus, Oculus VR, Rift, and the Oculus logo ("Oculus Marks") are trademarks or registered trademarks of Oculus VR, LLC. HTC, the HTC logo, HTC One and HTC Sense are the trademarks or registered trademarks in the U.S. and/or other countries of HTC Corporation and its affiliates. All other trademarks are property of their respective owners.

VIRZOOM LIMITED WARRANTY

This limited Warranty ("the Warranty") is offered by VirZOOM, Inc. ("VirZOOM," "we," or "us"). This Limited Warranty applies to a product consisting of physical goods, and only for physical goods, purchased from VirZOOM (the "Product").

Who is this limited Warranty to?

VirZOOM issues this Warranty to you, as a consumer who has purchased a new product from VirZOOM or an authorized retailer ("you"). This Warranty is only given to you, and may not be sold, transferred, or given in full or in part to any subsequent purchaser or acquirer of the Product or any other person. This Limited Warranty gives you specific legal rights, and you may also have other rights which vary from State to State. VirZOOM reserves the right to restrict warranty service to countries in which the product was intended to be sold.

What does this limited Warranty cover?

This Limited Warranty covers any defects in material or workmanship under normal use during the Warranty Period. During the Warranty Period, VirZOOM will repair or replace, at no charge, products or parts of a product that proves defective because of improper material or workmanship, under normal use and maintenance.

What will we do to correct problems?

VirZOOM will either repair or replace the Product at no charge, using new or refurbished replacement parts, or update services or software, so that the Product perform substantially according to the warranted functionality. The approach taken to resolve any issues will be at our sole choice. If we determine that the Product should be replaced, repair or replacement may include functionally equivalent remanufactured components or a new Product. If we determine that repair or replacement cost may not be reasonable, then we may refund to you part or all of the price you originally paid for the Product.

How long does the coverage last?

The Warranty Period for the Product's frame is 365 days from the date of purchase, and the Warranty Period for the Product's parts and electronics is 90 days from the date of purchase. A replacement Product or part assumes the remaining warranty of the original Product or 90 days from the date of replacement or repair, whichever is longer.

What does this limited Warranty not cover?

This Limited Warranty does not cover any problem that is caused by conditions, malfunctions or damage not resulting from defects in material or workmanship. The Product is designed to be used on average 30 to 60 minutes per day, 5 days per week. If used this way the Product should provide several years of service. However, use in excess of this rate may significantly reduce the lifespan of the Product. This Warranty is null and void for all commercial applications of the product. The Product is for personal residential (home) use by the purchaser only, not for rental or any commercial use.

How can you get service?

To obtain Warranty service, you must first contact us to determine the problem and the most appropriate solution for you. If you have a problem with VirZOOM, please visit www.virzoom.com/support for helpful service and contact information.